



KARNATAK LAW SOCIETY'S

RAJA LAKHAMGOUDA LAW COLLEGE, BELAGAVI

(AFFILIATED TO KARNATAKA STATE LAW UNIVERSITY, HUBBALLI & RECOGNISED BY BAR COUNCIL OF INDIA)



# R. L. LAW COLLEGE

# PLAYGROUND

# LOCATION PLAN

R.L.L.C.



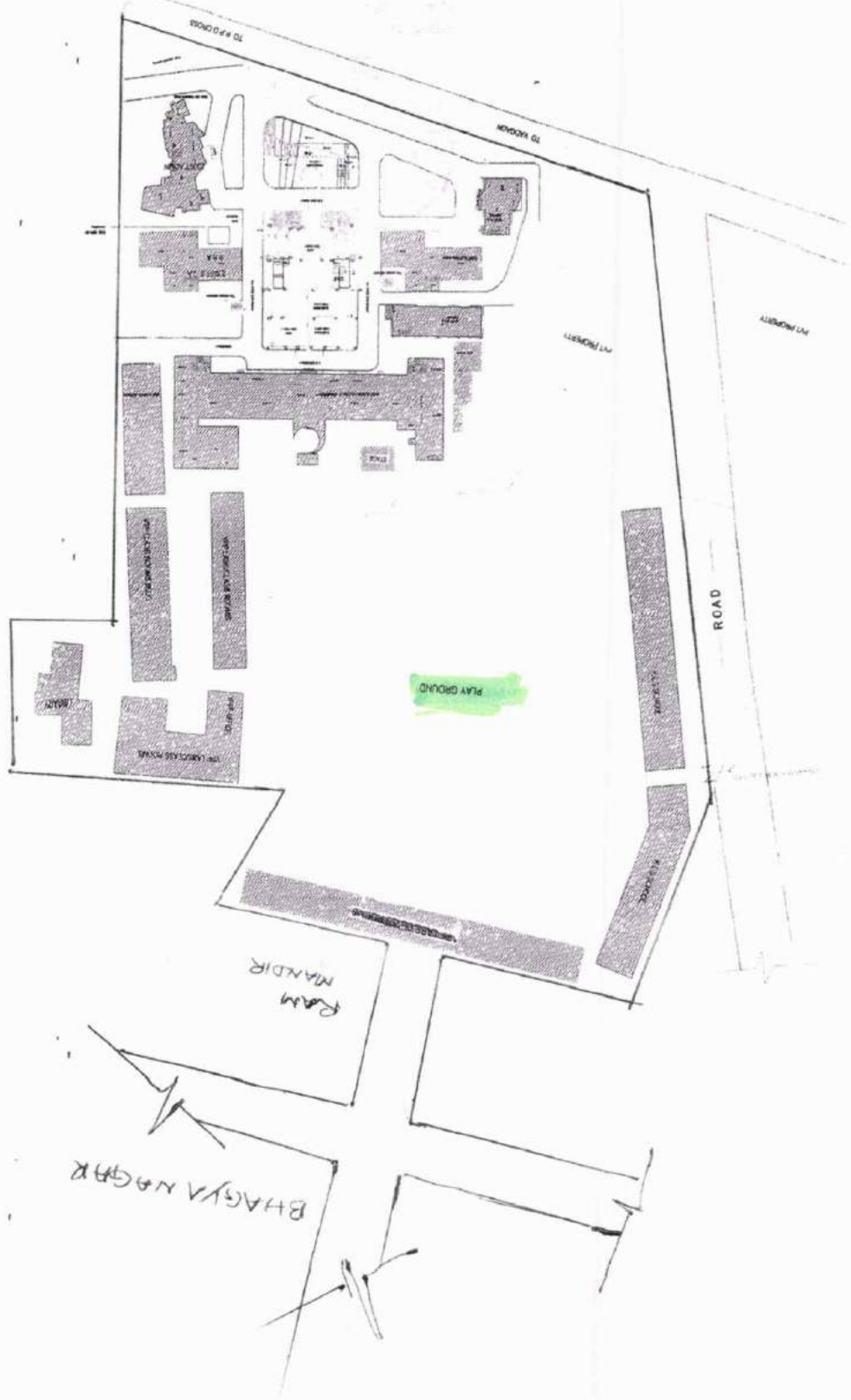

*Sudha*  
Principal  
R.L. Law College  
Belagavi



KARNATAK LAW SOCIETY'S

RAJA LAKHAMGOUDA LAW COLLEGE, BELAGAVI

(AFFILIATED TO KARNATAKA STATE LAW UNIVERSITY, HUBBALLI & RECOGNISED BY BAR COUNCIL OF INDIA)



**R. L. LAW COLLEGE  
PLATINUM JUBILEE  
BUILDING  
I - FLOOR MAP**



KLS PLATINUM JUBILEE BUILDING

R.L. Law College  
Principal  
Belagavi



MODELLING AUDITORIUM, GYMKHANA for SOCIETY CAMPUS at BELGAUM.

ARCHITECT



**KEMBHAVI**  
ARCHITECTURE FOUNDATION

"AUGUST HOUSE",  
PLOT NO-40 BEHIND PAI HOTEL  
BAILAPPANAVAR NAGAR, HUBLI,  
TEL NO:-2251324/2352776/5250005

#1972, 11TH MAIN, 38TH 'A' CROSS,  
4TH 'T' BLOCK, JAYANAGAR, BANGALORE  
Tel: OFF: 22441557, 21442734  
Website: www.kembhaviarchitects.com  
E-mail: kaf.blr@kembhaviarchitects.com

DRAWING TITLE

OPTION -02

DATE **22**  
20-04-2018

SCALE

NTS

ORIENTATION

SHEET NO.

01

CONTENTS

• ARCHITECTURAL DRAWINGS

| SL.NO | Particulars   | Dwg.No  |
|-------|---|---------|
| 1.    | Ground floor Working drawing plan   | 1752/34 |
| 2.    | First floor Working drawing plan  | 1752/35 |
| 3.    | Second floor Working drawing plan   | 1752/36 |
| 4.    | Third floor Working drawing plan  | 1752/37 |
| 5.    | Ground floor Furniture layout   | 1752/40 |
| 6.    | First floor Furniture layout  | 1752/41 |
| 7.    | Second floor Furniture layout   | 1752/42 |
| 8.    | Third floor Furniture layout  | 1752/43 |
| 9.    | Front Elevation   | 1752/44 |
| 10.   | Rear Elevation  | 1752/45 |
| 11.   | Left side Elevation   | 1752/46 |
| 12.   | Right side Elevation  | 1752/47 |
| 13.   | Security rm wall & Entrance steps, Jali Details   | 1752/49 |
| 14.   | First floor Moot Court Ceiling & Cladding details   | 1752/50 |
| 15.   | Gate plan, Centre line plan, Roof plan, Front,Rear & Side Elevations<br>Sections @ A-A, B-B, Enlarged details | 1752/51 |
| 16.   | Doors Schedule  | 1752/52 |
| 17.   | Window details  | 1752/53 |

• STRUCTURAL DRAWINGS

| SL.NO          | Particulars  | Dwg.No        |
|----------------|--|---------------|
| 1.             | R.C.C. Details of Entrance steps foundation        | 1752/ str 20a |
| 2.             | R.C.C. Details of G.F Top                          | 1752/ str 27  |
| 3.             | R.C.C. Details of F.F Top Level                    | 1752/ str 28  |
| 4.             | R.C.C. Details of F.F Top Level ( Revised )        | 1752/ str 29  |
| 5.             | R.C.C. Details of T.F Top Level                    | 1752/ str 30  |
| 6.             | R.C.C. Details at Beam layout for T.F Top          | 1752/ str 31  |
| 7.             | R.C.C. Details of U.G.W.T.                         | 1752/ str 35  |
| 8.             | R.C.C. Details of Basement bottom and Plinth level | 1752/ str 36  |
| • ROOF TRUSSES |  |               |
| 9.             | Configuration of Roof Truss                        | 01            |
| 10.            | Fabrication details of Roof Truss                  | 02, 03        |



REMODELLING AUDITORIUM, GYMKHANA for KARNATAKA LAW SOCIETY CAMPUS at BELGAUM

*Principal*  
R.L. Law College  
Belagavi

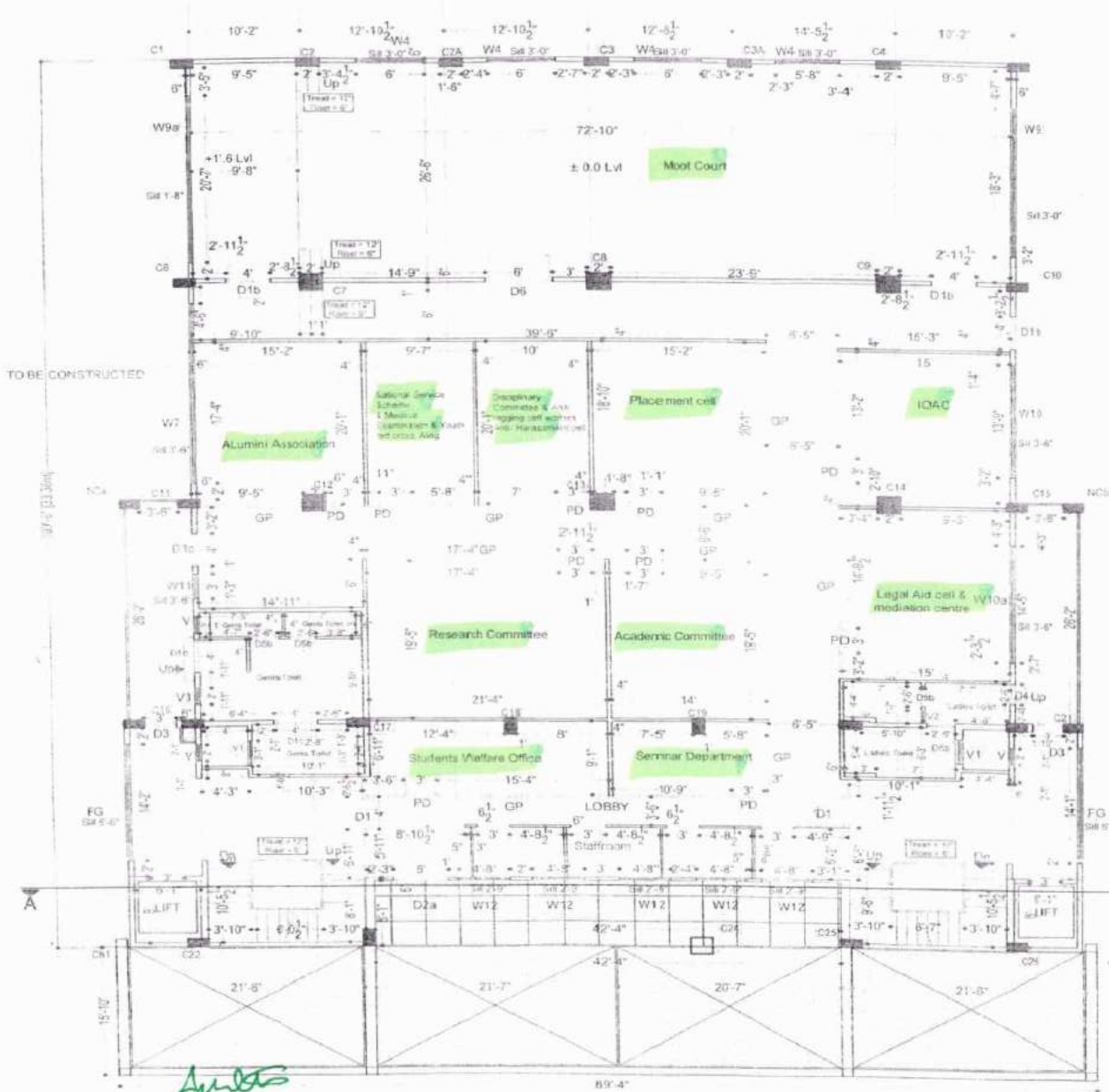

SCHEDULE OF OPENINGS

| Windows    | Nos |
|------------|-----|
| W4         | 4   |
| W7         | 1   |
| W9a        | 1   |
| W9b        | 1   |
| W10        | 1   |
| W10a       | 1   |
| W11        | 1   |
| W12        | 5   |
| FG         | 2   |
| Ventilator |     |
| V          | 3   |
| V1         | 2   |
| V3         | 1   |

| Doors | Nos |
|-------|-----|
| PD    | 10  |
| D1    | 2   |
| D3a   | 5   |
| D3c   | 2   |
| D3    | 2   |
| D4    | 1   |
| D5b   | 4   |
| D6    | 1   |

No. NOTES  
CONTRACTOR TO CHECK ALL THE DIMENSIONS ON SITE

No. REVISION DATE

First floor Working Drawing

Kembhavi Architecture Foundation  
"AUGUST HOUSE"  
PL 31/NO.45 BEHIND RAI HOTEL  
BALAPPANAYAKR NAGAR, HUBLI  
TEL. NO. 2251321 / 2352775 / 5256965

BRANCH:  
# 1872, 11th main, 38th & 4th cross  
Bijayanagar, 1st & 7th block  
Ph. No. 986-22441557 / 22442734

SCALE NTS  
DATE 18 - MARCH 2018

Drawn by: [Signature]  
Checked by: [Signature]  
Drg. No. 1752



FIRST FLOOR PLAN  
Principal  
R.L. Law College  
Belagavi



**KARNATAK LAW SOCIETY'S**

**RAJA LAKHAMGOUDA LAW COLLEGE, BELAGAVI**

(AFFILIATED TO KARNATAKA STATE LAW UNIVERSITY, HUBBALLI & RECOGNISED BY BAR COUNCIL OF INDIA)



**R. L. LAW COLLEGE  
PLATINUM JUBILEE  
BUILDING  
AUDITORIUM  
III-FLOOR MAP**

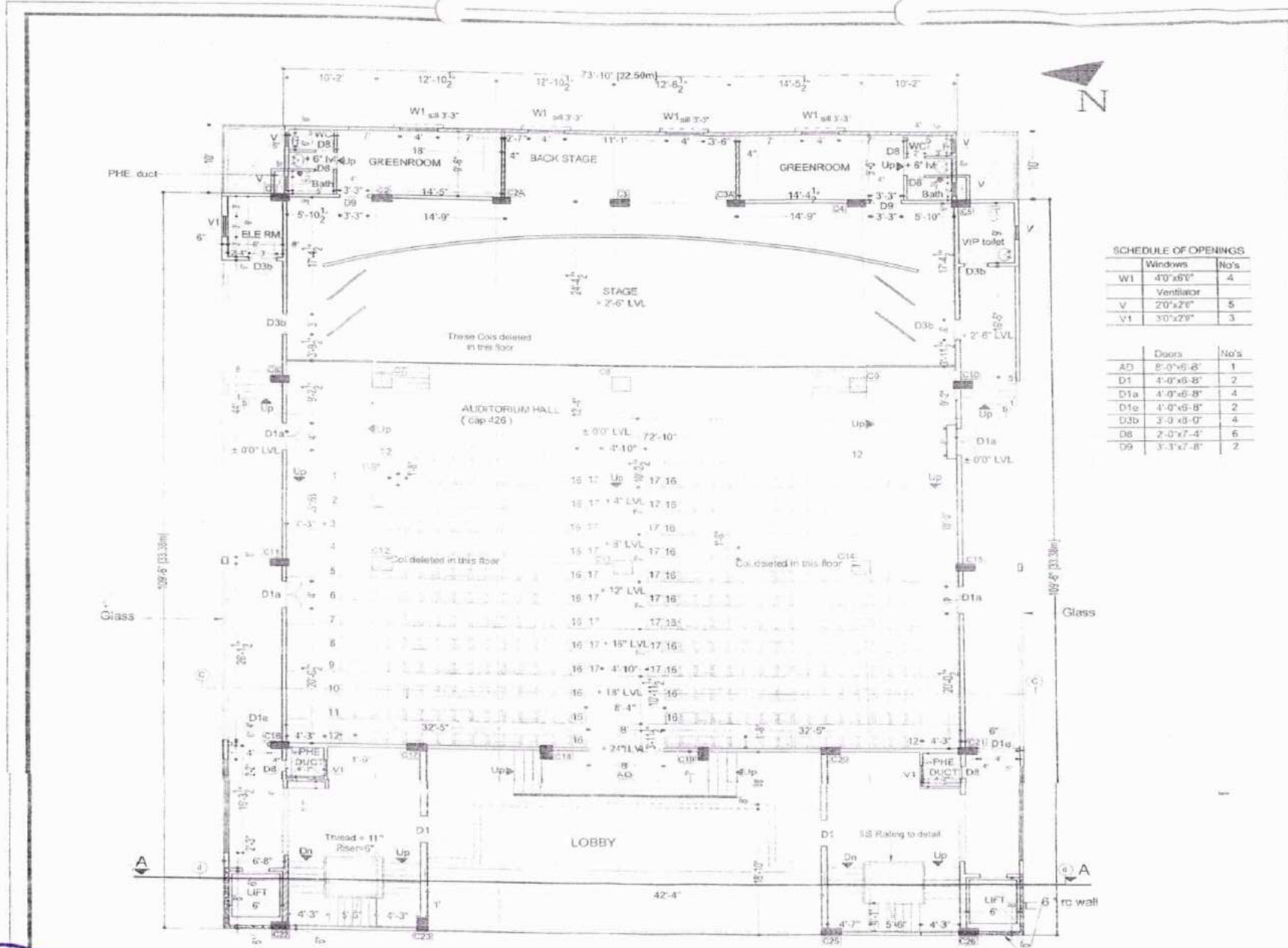

**SCHEDULE OF OPENINGS**

| Windows      | No's |
|--------------|------|
| W1 4'0"x6'0" | 4    |
| Ventilator   |      |
| V 2'0"x2'6"  | 5    |
| V1 3'0"x2'0" | 3    |

| Doors         | No's |
|---------------|------|
| AD 8'0"x6'8"  | 1    |
| D1 4'0"x6'8"  | 2    |
| D1a 4'0"x6'8" | 4    |
| D1e 4'0"x6'8" | 2    |
| D3b 3'0"x6'0" | 4    |
| D8 2'0"x7'4"  | 6    |
| D9 3'3"x7'8"  | 2    |

No. NOTES

CONTRACTOR TO CHECK ALL THE DIMENSIONS OF SITE

No. REVISION DATE

Third floor Working Drawing

Refer to drawing  
 Kambhavi Architecture Foundation  
 PLOT NO-45 BEHIND PAU HOTEL  
 BALAPPANAVAR NAGAR, HUBLI  
 TEL. NO - 0251301 / 252776 / 5250005

BRANCH:-  
 # 10/2, 11 & main 38th 'A' cross  
 Jayangal 4th T block  
 Ph. No. 025 2558155 / 2552754

SCALE NTS  
 DATE 19 - MARCH 2018

Drg. No. 1752/37



*Sultra*  
 Principal  
 R.L. Law College  
 Belagavi

THIRD FLOOR PLAN

REPAIRING AUDITORIUM, GYMKHANA for KARNATAKA LAW SOCIETY CAMPUS at BELGAUM



Karnatak Law Society's  
**Raja Lakhamgouda Law College**

Tialkwadi, Belagavi-590006  
Details of College Infrastructure

| Particulars   | Total No. | Measurement        |
|---|-----------|--------------------|
| <b>CLASS ROOMS:</b>   |           |                    |
| Ground Floor (with audio visual facility)   | 2         | 30X40              |
| First Floor (with audio visual facility)  | 2         | 30X40              |
| Second Floor (with audio visual facility)   | 4         | 15X20              |
| <b>CLASS ROOMS:</b><br>(on 2nd floor of Library Building one class room with audio visual facility) | 2         | 31X26              |
| <b>PRINCIPAL CHAMBER</b>  |           |                    |
| Chamber   | 1         | 32X35              |
| Toilet  | 1         | 06X04              |
| Strong Room   | 1         | 06X04              |
| <b>OFFICE</b>   |           |                    |
| Office  | 1         | 33X35              |
| Store Room  | 1         | 08X35              |
| Toilet  | 2         | 06X04              |
| Passage   | 1         | 07X14              |
| <b>COMMON HALL (First floor Admn Bldg)</b>  | 1         | 52X35              |
| Toilet  | 2         | 06X02              |
| Toilets in RLLC Building  | 3         | 08X10              |
|   | 1         | 14X14              |
|   | 1         | 14X09              |
| <b>LIBRARY</b>  |           |                    |
| Stack Room  | 1         | 2200 SQFT          |
| Reading Room  | 1         | 2200 SQFT          |
| <b>COMPUTER CENTER</b>  | 1         | 31X22              |
|   | 1         | 22X20              |
| <b>LADIES ROOM</b>  |           |                    |
| attached with three toilets   | 1         | 42X25              |
| Free Legal Aid Cell Room  | 1         | 07X07              |
| Hall (old Moot Court 3rd floor Lib Bldg)  | 1         | 12X15              |
| Seminar Hall  | 1         | 13X21              |
| Moot Court Office   | 1         | 12X15              |
| NAAC - IQAC Office  | 1         | 13X21              |
| Gym Hall (basement PJB)   | 1         | 30X35              |
| Gymkhana Hall (under construction)  | 1         | -                  |
| Boys Roste Rooms  | 14        | 10X15              |
| Ladies Hostel Rooms   | 8         | 10X15              |
| Play Ground   | 1         | 4.01 Acres         |
| New Moot Court Hall (PJB)   | 1         | 73X27              |
| Staff Room (PJB)  | 1         | 42X6               |
| Research Committee (PJB)  | 1         | 22X20              |
| Academic Committee (PJB)  | 1         | 14X20              |
| Leagal Aid Cell (PJB)   | 1         | 15X21              |
| New IQAC (PJB)  | 1         | 15X19              |
| Placement cell (PJB)  | 1         | 16X20              |
| Anti Ragging Cell (PJB)   | 1         | 10X20              |
| NSS & Red Cross Room (PJB)  | 1         | 10X20              |
| Alumni Association (PJB)  | 1         | 15X20              |
| Student Welfare Dept (PJB)  | 1         | 22X08              |
| Seminar Dept. (PJB)   | 1         | 14X08              |
| <b>Total Area of the College</b>  |           | <b>11.27 Acres</b> |

**Other Facilities:**

We are also having Bank, Post Office, Common Canteen and mess facilities in campus.

Following additional facilities/equipments are provided for the benefit of the students

- 1) Internet facility 24 hours with wi-fi (25 MBPS line) accessible in entire campus.
- 2) Multi Gym, 3) Fax Machine 4) LED TVs 5) Over head projectors 6) Water Coller/Purifier
- 8) Library and Respository Services with & outside the campus 9) DLP Projectors in all class rooms
- 10) Interactive white boards in class rooms 11) Digital Camara 12) Generator 15 KV
- 13) Inverter for reading room 14) Laptos for presentation 15) SMS facility to communicate with students and parents